

QUICK REFERENCE GUIDE

WARNING

This Quick Start Guide does not replace the User's Manual for your Accu-Chek FastClix lancing device. The User's Manual contains important handling instructions and additional information.

WARNING

The Accu-Chek FastClix lancing device is intended for patient self-monitoring by an individual person only. It must not be used to collect blood from more than one person as it does not incorporate any features to guard against cross-infection.

OVERVIEW



The simple handling steps

PREPARING FOR LANCING



1. Wash your hands

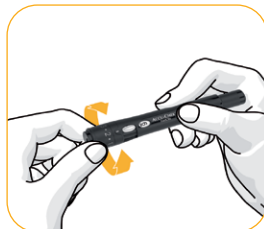

2. Select from 11 depth settings

INSERTING A DRUM

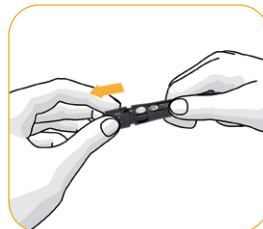

3. Remove cap

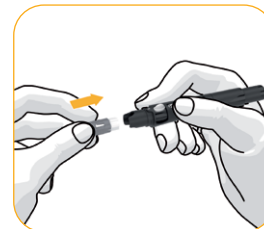

4. Insert lancet drum

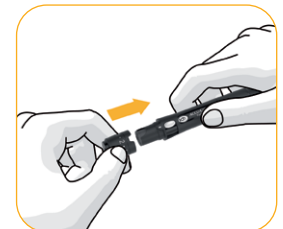

5. Replace cap

OBTAINING A BLOOD SAMPLE

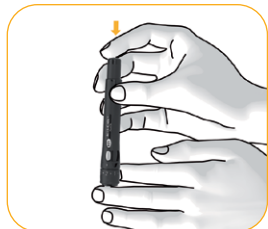

6. Prick and release in 1-Click action

CHANGING LANCETS



7. Slide lever back and forth to change to a new lancet.



Unused drum



Used drum

Use all 6 lancets before removing the drum. The drum cannot be reinserted for hygienic reasons.

Experience 1-Click lancing. Your fingertips will thank you.

© 2022 Roche Diabetes Care Limited. All rights reserved.

ACCU-CHEK and FASTCLIX are trademarks of Roche. All other trademarks or brand names are the property of their respective owners.

Roche Diabetes Care Limited, Charles Avenue, Burgess Hill, West Sussex, RH15 9RY, UK.
Company Registration Number: 09055599

Date of preparation: February 2022

Material number: 09689508001

For use in the UK and Ireland only

www.accu-chek.co.uk www.accu-chek.ie